



IN-Line Consulting, LLC

402 Bell Court
Woodstock, GA 30188

Insured: Public Risk Management - Sun 'N Lakes Water
Treatment Location 5 Buildings A -E & PIT
Property: 5306 Sun N Lake Boulevard
Sebring, FL 33872

Estimator: David Beard
Position: Executive Consultant
Company: IN-Line Consulting, LLC
Business: 7021 Grand National Drive, Suite 107
Orlando, FL 32819

Business: (321) 689-8022
E-mail: dbeard@inline.us

Claim Number: MULTIPLE

Policy Number: MULTIPLE

Type of Loss: Hail

Coverage	Deductible	Policy Limit
Commercial	\$0.00	\$0.00
Water Treatment A	\$0.00	\$0.00
Fence PITO A	\$0.00	\$0.00

Date Contacted: 5/13/2022 3:43 PM

Date of Loss: 4/4/2022 3:43 PM

Date Inspected: 5/13/2022 3:43 PM

Date Received: 5/13/2022 3:43 PM

Date Entered: 5/13/2022 3:43 PM

Price List: FLSE8X_APR22
Restoration/Service/Remodel

Estimate: SNL-0005-A

Branch-File#: 3975474



File No.: 22-5800

Claim No.: MULTIPLE

Client File No.: 3975474

This estimate is preliminary and subject to review and revision.

This estimate does not address any code upgrades which may be required.

Created by IN-Line Consulting, LLC. All rights reserved. Printed in the United States of America. No part of this document may be reproduced, stored in a retrieval system, or transmitted in any form by any means, electronic, mechanical, photocopying, recording, or otherwise, without the prior written permission of IN-Line Consulting, LLC.

IN-Line Consulting, LLC shall not be responsible for any loss, liability, damage, expense or cost arising from any use of the IN-Line Consulting, LLC analysis, reports, certifications or advice, which is used by anyone other than the Client or is used contrary to, or inconsistent with, or beyond the provisions and purposes set forth herein. Client understands and agrees that the IN-Line Consulting, LLC analysis, reports, and certifications shall be used solely by the Client.

The documents are furnished for Client's exclusive internal use and reliance, only. All documents generated by IN-Line Consulting, LLC shall remain the sole property of IN-Line Consulting, LLC. Any unauthorized use or distribution of the IN-Line Consulting, LLC work shall be at Client's and recipient's sole risk and without liability to IN-Line Consulting, LLC.

SNL-0005-A
Water Treatment
Water Treatment Bldg A
Pump Room A

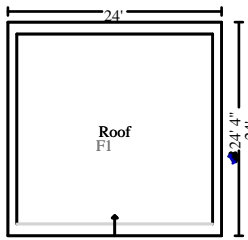
Roof

583.95 Surface Area	5.84 Number of Squares
96.66 Total Perimeter Length	

DESCRIPTION
QTY

1. R&R Modified bitumen roof	5.84 SQ
2. R&R Flashing, 14" wide	96.66 LF
3. R&R Roof vent - turbine type	1.00 EA
4. R&R Fascia - metal - 6"	96.66 LF

NOTES:

Front Elevation
DESCRIPTION
QTY

5. Seal & paint column - two coats	16.00 LF
6. Prime & paint exterior fascia - metal, 4"- 6" wide	24.00 LF
7. Mask the surface area per square foot - plastic and tape - 4 mil	70.00 SF
8. R&R Metal roofing	98.00 SF
Front awning.	



CONTINUED - Front Elevation

DESCRIPTION	QTY
-------------	-----

NOTES:

Right Elevation

DESCRIPTION	QTY
-------------	-----

9. Prime & paint exterior fascia - metal, 4" - 6" wide	24.00 LF
--	----------

NOTES:

Left Elevation

DESCRIPTION	QTY
-------------	-----

10. Material Only Spot light fixture - double	1.00 EA
11. Prime & paint exterior fascia - metal, 4" - 6" wide	24.00 LF
12. Electrician - per hour	3.00 HR
Replacement of spotlight.	

NOTES:

Rear Elevation

DESCRIPTION	QTY
13. Prime & paint exterior fascia - metal, 4" - 6" wide	24.00 LF
14. R&R Window screen, 17 - 25 SF	1.00 EA

NOTES:

Equipment

DESCRIPTION	QTY
15. Rental equipment delivery / mobilization (Bid item)	0.33 EA
Pick up and delivery of equipment.	
16. Telehandler/forklift and operator	1.33 HR
Loading of materials.	

NOTES:

Chemical Storage Shed A

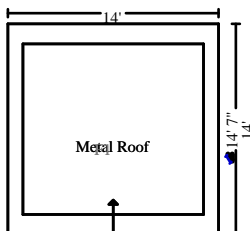

Metal Roof

203.84 Surface Area	2.04 Number of Squares
57.12 Total Perimeter Length	

DESCRIPTION	QTY
17. R&R Metal roofing	203.84 SF
18. R&R Fascia - metal - 6"	57.12 LF

CONTINUED - Metal Roof

DESCRIPTION	QTY
-------------	-----

NOTES:

Equipment

DESCRIPTION	QTY
-------------	-----

19. Rental equipment delivery / mobilization (Bid item)	0.33 EA
Pick up and delivery of equipment.	
20. Telehandler/forklift and operator	1.33 HR
Loading of materials.	

NOTES:

General Conditions

DESCRIPTION	QTY
-------------	-----

21. Taxes, insurance, permits & fees (Bid Item)	2.00 EA
https://sebring-airport.com/wp-content/uploads/2015/08/Building_Fee_Schedule_Revised_For_10_1_14.pdf	
22. General Laborer - per hour	8.00 HR
Keep work areas safe and clean.	
23. Commercial Supervision / Project Management - per hour	2.00 HR
Supervision of sub contractors and be resent for building inspections.	
24. Temporary toilet (per month)	0.40 MO

CONTINUED - General Conditions

DESCRIPTION	QTY
-------------	-----

NOTES:

Fence PITO A

DESCRIPTION	QTY
25. R&R Chain link fence - wind / privacy screen - 6' high	150.00 LF
26. Commercial Supervision / Project Management - per hour Supervision of sub contractors and be resent for building inspections.	2.00 HR
27. Temporary toilet (per month)	0.20 MO

NOTES:

Grand Total Areas:

0.00 SF Walls	0.00 SF Ceiling	0.00 SF Walls and Ceiling
0.00 SF Floor	0.00 SY Flooring	0.00 LF Floor Perimeter
0.00 SF Long Wall	0.00 SF Short Wall	0.00 LF Ceil. Perimeter
0.00 Floor Area	0.00 Total Area	0.00 Interior Wall Area
237.04 Exterior Wall Area	0.00 Exterior Perimeter of Walls	
787.79 Surface Area	7.88 Number of Squares	153.78 Total Perimeter Length
0.00 Total Ridge Length	0.00 Total Hip Length	

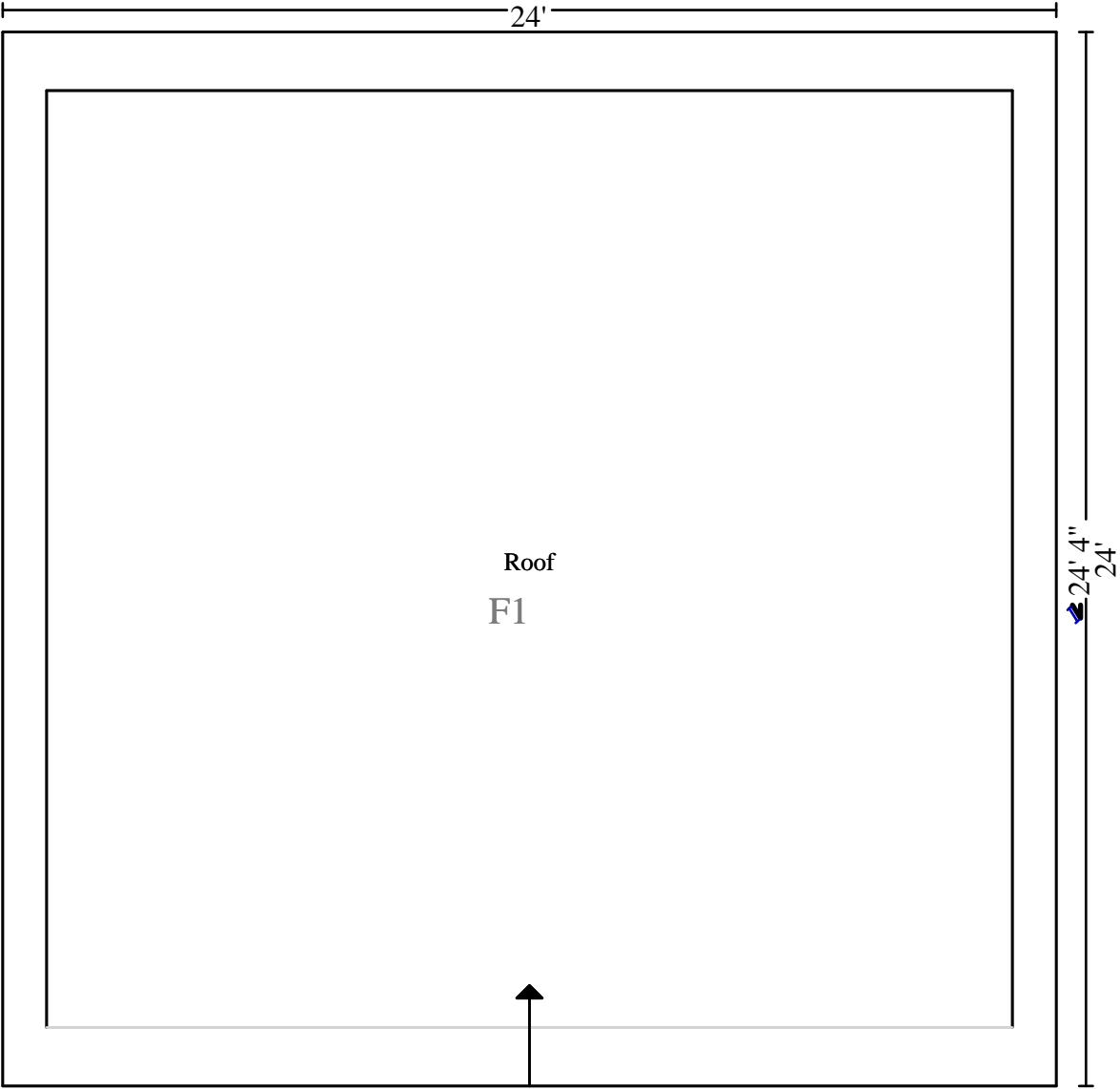

Pump Room A

